

DRAWING FOR CUSTOMER

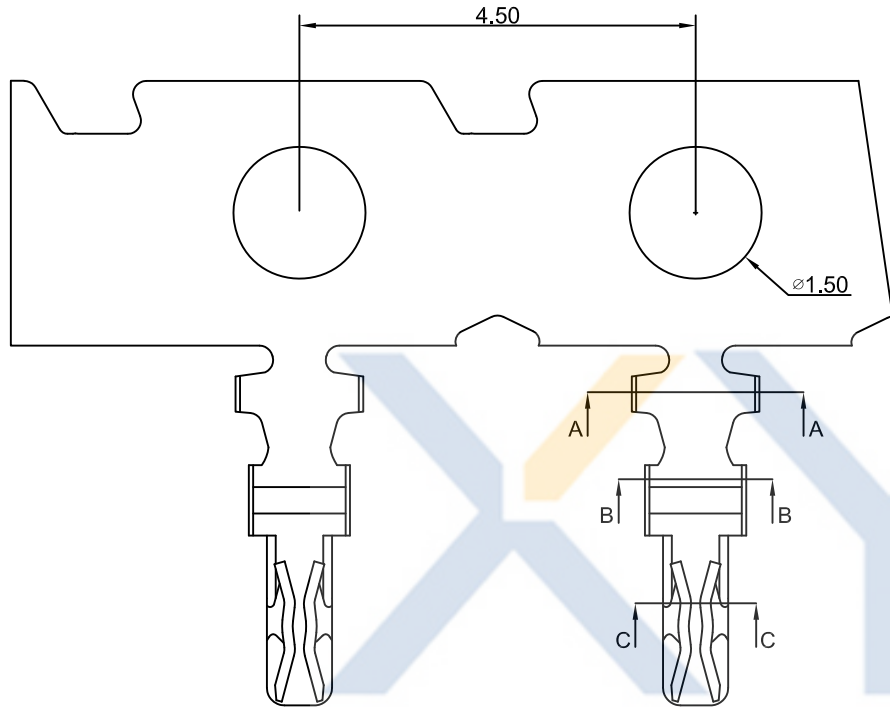

$0.12^{+0.03}_{-0.01}$

- SPEC.:
- Rated Voltage:50V AC,DC
 - Rated Current:1A AC,DC
 - Withstand Voltage:500V AC/minute
 - Contact Resistance:20mΩ max
 - Insulation Resistance:100MΩ min
 - Temperature Range:-25℃~+85℃
 - QTY.:15KPCS/Reel
- Terminal
- Material:Phosphor Bronze C5191
 - Finish:Tin-plated,over Nickel
 - Applicable wire:AWG#28~32

KB901-XXXT1A

1:All plated
2:Half plated

Plating

0: Tin-plat
1: Gold Plat1u"
2: Gold Plat3u"
3: Gold Plat5u"

Version
Mold No.
Terminal

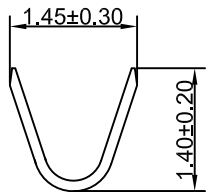

Section:A-A

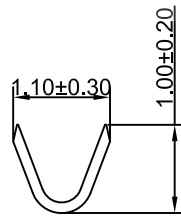

Section:B-B

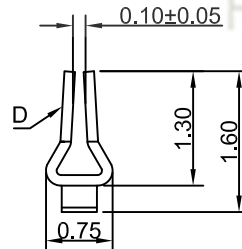

Section:C-C

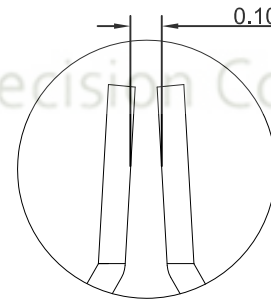
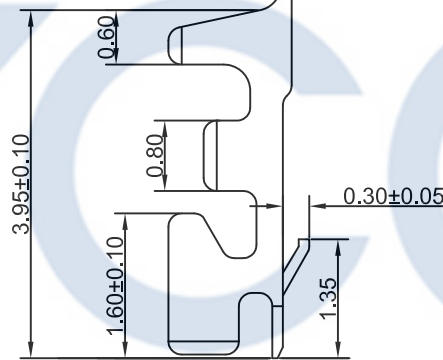

DETAIL D

XYCO PRECISION CONNECTORS

TEL: 0769-8297 9981/2/3 <http://www.XYCO.com.cn>

2015-05-13	A-1	优化产品	KB901-XXT1A	John	TOLERANCE 公差	DRAWING 設計者	John	KB901-XXT1A	
2013-08-10	A		KB901-XXT1A	John	.X=±0.30 .XX=±0.20 .XXX=±0.10	CHECKED 審查	Thomas	PART NO. 料號	
DATE 日期	VER 版本	CHANGE HISTORY 變更歷史	CHANGED NAME 修改後料號	DRAWING 變更者		APPROVED 核准	William	DWG NO. 圖號	PE2006A

UNIT 單位	mm	PRODUCT NAME 產品名稱	JST SH1.0mm Wire to Board Terminal
------------	----	----------------------	---------------------------------------