

DRAWING FOR CUSTOMER

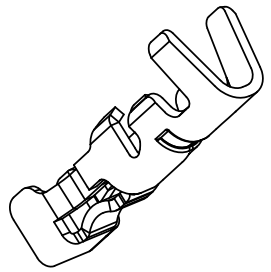
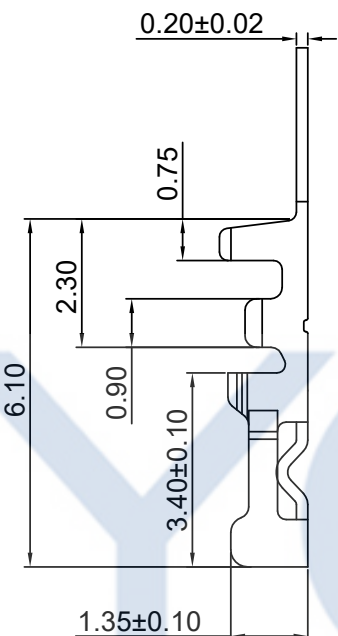
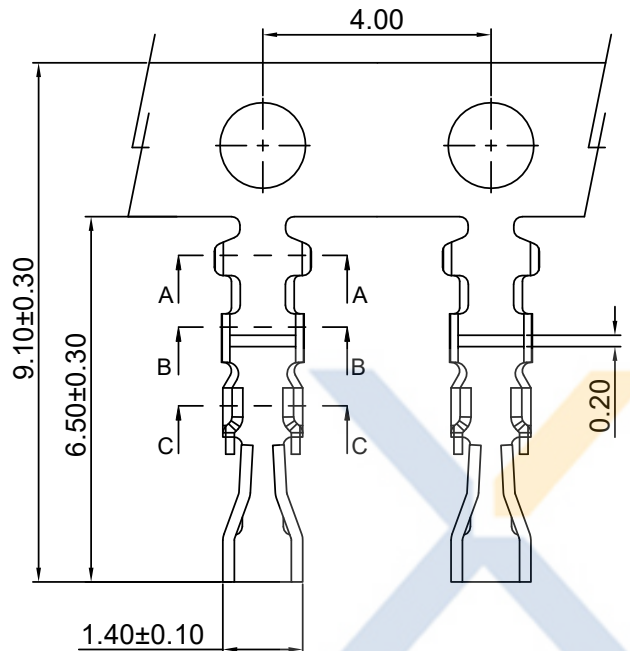

- SPEC.:
- Voltage Rating:250V AC/DC
 - Current Rating:2A AC/DC
 - Dielectric Strength :500V AC/minute
 - Insulation Resistance:1000MΩ min.
 - Temperature Range:-25°C to+85°C.
 - Contact Resistance:20mΩ max.

- Terminal:
- Material:Brass C2680
 - Finish:Gold/Tin Plated Over Nickel Plated
 - Applicable Wire:AWG#26~30
 - Q'ty:20KPCS/Reel

KB931-XXT2A

- 1:All plated
- 2:Half plated

Version

Mold No.

Terminal

- 0: Tin-plat
- 1: Gold Flash
- 2: Gold Plat 3u"
- 3: Gold Plat 5u"

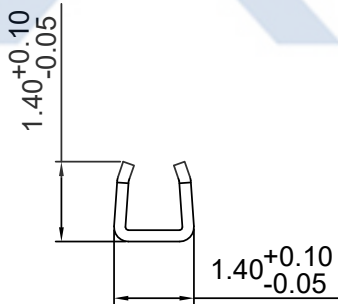
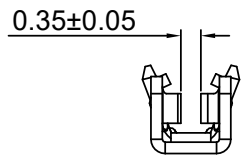

Section:C-C

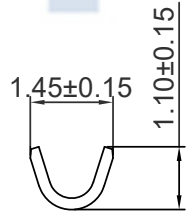

Section:B-B

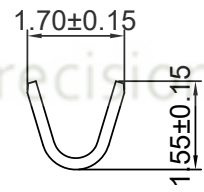

Section:A-A

XYCO 东莞市轩业电子科技有限公司
TEL: 0769-8297 9981/2/3 <http://www.XYCO.com.cn>

2022-11-10		A	开设步距4.0mm模具	KB931-XXT2A	Devin	TOLERANCE 公差	DRAWING 設計者	Devin	KB931-XXT2A		UNIT 單位		mm	PRODUCT NAME 產品名稱	DP2.0mm Wire To Board Terminal
DATE 日期	VER 版本	CHANGE HISTORY 變更歷史		CHANGED NAME 修改後料號	DRAWING 變更者	.X=±0.30 .XX=±0.20 .XXX=±0.10	CHECKED 審查	Thomas	PART NO. 料號	DWG NO. 圖號	PE3504A				
1	2	3		4	5	6	7	8	9						